

P Series Puller

1000 and 2000 lb Capacity



Features / Wire Puller:

- 4:1 design factor. Meets ASME B30.21.
- Handle and frame are heavy gauge steel with rivet construction and slip-resistant grip. All steel parts are plated for years of useful life.
- Exclusive long life "buttress tooth" cast gear design has no laminated plates to separate or wear and provides maximum strength.
- Sturdy steel drive and holding pawls have long life, stainless steel springs. All pivot points are hardened steel.
- Safety latch hooks are drop forged steel, heat treated and plated for corrosion resistance. Top hook rotates 360° for easy operation.
- Cast-aluminum drum has a "through-the-drum" anchor, larger diameter and a drum guard. This means the wire rope won't come loose, bends less so it lasts longer and spools evenly while rewinding.
- Galvanized aircraft quality wire rope is preformed to prevent kinks.
- One year warranty.

Features / Rope Puller:

- Two models with either 25 or 75 foot rope length.
- Standard with oversized $\frac{5}{8}$ inch diameter high strength polyester rope.
- Rope has less chance to mar surfaces or kink and is easier to manage than wire cable.
- Rope is non-conductive and can be stored or used separately.
- Rope pullers can handle long pulls or reaches limited only by the length of rope available.
- The Ingersoll-Rand rope puller is easy to pay out rope and will not bind the rope in the drum after pulling a load.

P Series Specifications and Dimensions

Model no.	No. of lines	Rated cap. lifting 4:1 lbs	Min. 'A' dist. btwn hooks in.	Lifting distance ft	Cable diameter in.	No. of hooks	Net weight lbs
P15H	Single	1000	19 $\frac{1}{2}$	15	$\frac{3}{16}$	2	8
P15D3H	Single	1000	21	15	$\frac{3}{16}$	3	10
P15D3H	Double	2000	27 $\frac{1}{2}$	7 $\frac{1}{2}$	$\frac{3}{16}$	3	10
PR-25	Single	1100	24	23	$\frac{5}{8}$	2	10.8
PR-75	Single	1100	24	73	$\frac{5}{8}$	2	17.4

Note:

Dimensions are subject to change.

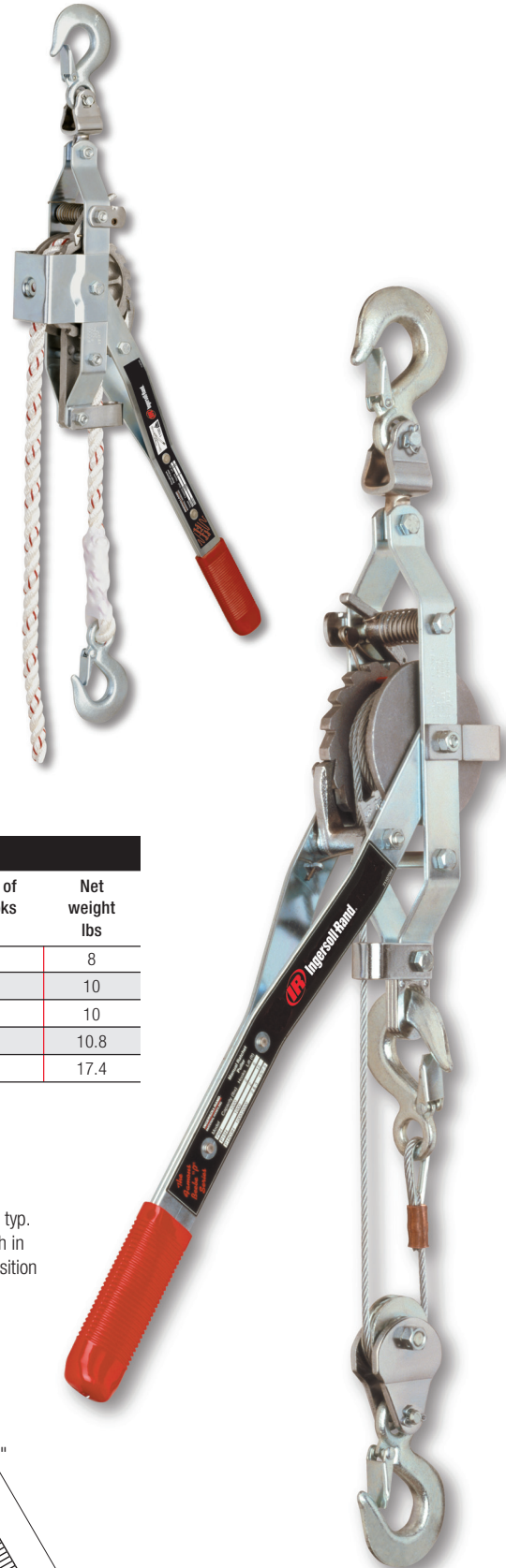
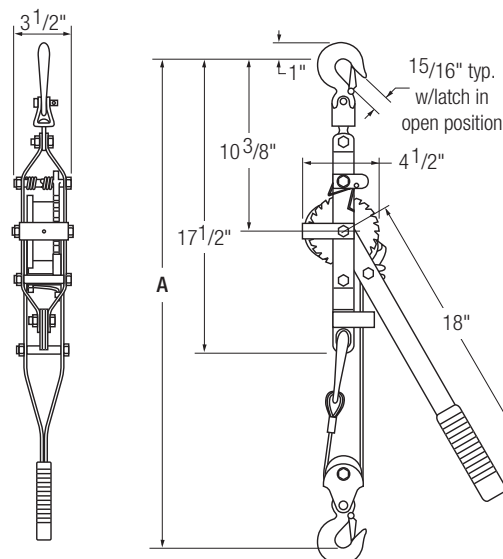

C Series Puller

1700 – 4000 lb Capacity



Features / Cable Puller:

- 4:1 design factor lifting, lowering and pulling. Meets ASME B30.21.
- Overload safety handle designed to noticeably bend.
- Lightweight aluminum frame.
- Alloy steel load hook with safety latches.
- One piece cast aluminum drum.
- Buttruss tooth design improves load gear life.
- Solid steel drive and holding dog, not laminated plates.
- Galvanized aircraft quality wire rope.
- Ratchet and pawl system provides safe, "one notch at a time" lowering.
- Cable guide and shield protects wire rope and spools cable evenly on drum.
- Reversible handle changes position easily, so pull is always possible in the right direction against the load.
- Easy to repair, replacement parts available.
- Plated external parts for corrosion resistance.

Features / Strap Puller:

An extension of our premium C Series, the C Series strap pullers offer the following unique features:

- Three hooks allow 2 ton capacity; 6 foot pull with double line and 1 ton capacity with 12 foot pull using single line.
- Non-conductive, corrosion resistant, high strength synthetic strap will not kink or bind.
- Easy pay out of strap for fast set-up.



C Series Specifications

Model no.	No. of lines	Rated cap. lifting 4:1 lbs	Min. 'A' dist. btwn hooks in.	Lifting distance ft	Cable diameter in.	No. of hooks	Net weight lbs
C400H	Single	1700	17	20	1/4	2	16
C400H	Double	3400	22	10	1/4	3	16
C400S	Single	2000	17	12	3/32 x 1 7/8	2	16
C400S	Double	4000	22	6	3/32 x 1 7/8	3	16

Note:
Dimensions are subject to change.

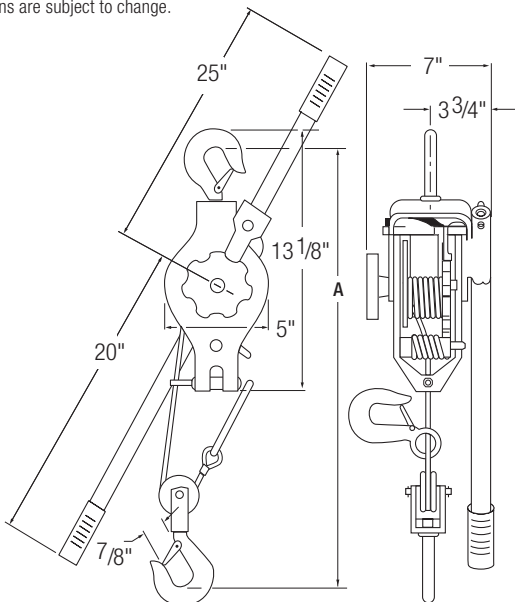

Overload safety handle is designed to bend when an overload is detected. Once the handle begins to bend, any additional force will result in additional bending limiting the hoist from lifting beyond it's capacity.

L5H “Premium” Series Lever Chain Hoist

3/4 – 6 metric ton Line Pull Capacity



Features

Our “top of the line” lever chain hoist. The ultimate in performance, endurance.

Enhanced safety

- Unique, innovative “Torsion-Lok” brake system ensures positive brake engagement.
- Free chain knob with color-coded red/green indicator window shows at a glance if hoist is in “load” or “free chain” position.
- Easy to read instructions are conveniently located on handle, and color coordinated with free chain knob.
- Wide throat, forged alloy steel load hooks have slip resistant barbed tips to better retain slings.
- Patented cast steel chain anchor prevents chain end from being pulled through hoist.

Improved performance

- Simple and convenient single-hand “free chaining” allows smooth, trouble-free operation in vertical or horizontal position.
- 360° rotation handle needs only 15° handle movement to ratchet and position loads, a big plus in tight places.
- Available in standard lifts of 5, 10, 15 and 20 feet.

Rugged construction

- Meets ASME B30.21 and HST-3M standards.
- High-strength, cold-formed, stamped steel construction decreases weight while increasing impact resistance.
- Open frame design for easy cleaning and inspection.
- Grade 100 alloy chain.
- Plated fasteners and springs increase reliability and durability.
- A comfortable slip resistant rubber grip handle - even with a glove.
- Top and bottom hooks rotate 360°. Top hook articulates, for flexibility in hard to reach places.

Options

- Plated load chain provides corrosion resistance.
- Overload slip clutch factory set to slip at 150% of rated capacity.
- Bullard bottom hooks for single fall models only.
- Non-standard lifts.



Lever Chain Hoists

L5H Series Specifications

Model no.	Capacity		Pull to lift rated load	Net wt of chain per ft of lift	No. of chain falls	Load chain size	Ship wt w/5 ft of lift
	metric tons	lbs				mm	
L5H150	3/4	1650	35	.57	1	6.3 x 19.2	15
L5H200	1 ⁽¹⁾	2000	43	.57	1	6.3 x 19.2	16
L5H300	1-1/2	3300	40	.74	1	7.1 x 21.2	21
L5H400	2 ⁽¹⁾	4000	49	.74	1	7.1 x 21.2	22
L5H600	3	6600	73	1.19	1	9.0 x 27.2	34
L5H1200	6	13200	77	2.38	2	9.0 x 27.2	62

Note:

Standard lift 5, 10, 15, and 20 ft.

(1) U.S. tons. 2000 lb rating for the 1 ton and 2 ton models only.

L5H Series Dimensions (in.)

Model no.	A (min)	B	C	D	E
L5H150	12.25	6	5	10.12	1.06
L5H200	12.25	6	5	10.12	1.06
L5H300	13.75	6.63	5.75	14.5	1.34
L5H400	13.75	6.63	5.75	14.5	1.34
L5H600	16.75	7.88	7.13	14.5	1.69
L5H1200	22.25	7.88	9.5	14.5	1.88

Note:

Dimensions are subject to change.

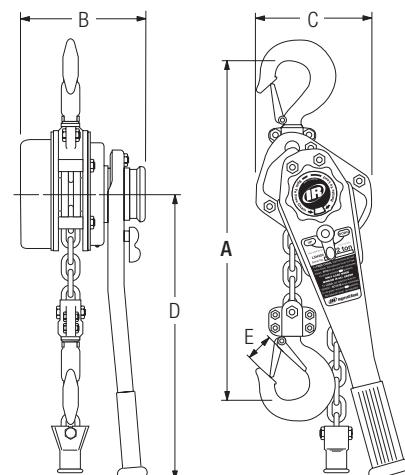

LV “Classic” Series Lever Chain Hoist

3/4 – 6 metric ton Line Pull Capacity



Features:

A rugged, dependable lever chain hoist with capacities and features that make it ideal for all industrial lifting, pulling and positioning applications.

Enhances safety

- Forged steel alloy load hooks have wide throat openings with slip resistant barbed tips to better retain slings.

Improved performance

- Minimal effort in compact design.
- Heat treated gears and pinions.
- 360° rotation handle needs only 15° handle movement to ratchet and position loads. A big plus in tight places.
- Responsive load control through six pinion gear teeth and a four pocket load sheave.
- Easy free chaining operation.
- Single fall, 3 ton model for increased portability.
- Double reduction gearing for superior spotting characteristics.
- A comfortable slip resistant rubber grip handle - even with a glove.
- Available in standard lifts of 5, 10, 15 and 20 feet.

Rugged construction

- Meets ASME B30.21 and HST-3M design and performance standards.
- High-strength, cold-formed, all stamped steel construction decreases weight while increasing external impact resistance.
- Open frame design for easy cleaning and inspection.
- Grade 100 alloy chain.

Options:

- Plated load chain provides corrosion resistance.
- Aircraft handling, free chain lockout kits.
- Bullard bottom hooks for single fall models only.
- Non-standard lifts.



LV Series Specifications

Model no.	Capacity		Pull to lift rated load lbs	Net wt of chain per ft of lift lbs	No. of chain falls	Load chain size mm	Ship wt w/5 ft of lift lbs
	metric tons	lbs					
LV150	3/4	1650	35	.57	1	6.3 x 19.2	15
LV300	1-1/2	3300	40	.74	1	7.1 x 21.2	21
LV600	3	6600	73	1.19	1	9.0 x 27.2	36
LV1200	6	13200	77	2.38	2	9.0 x 27.2	59

Note:

Standard lift 5, 10, 15, and 20 ft.

LV Series Dimensions (in.)

Model no.	A (min)	B	C	D	E
LV150	11.6	5.8	5.0	9.8	1.1
LV300	12.8	6.4	5.8	14.2	1.3
LV600	15.6	7.6	7.1	14.2	1.7
LV1200	23.2	7.6	9.3	14.2	1.9

Note:

Dimensions are subject to change.

New Option “L” Aircraft Handling, Free Chain Lockout Kits¹

Part no.	Used on models
LV150-KLOCK	All LV150
LV300-KLOCK	All LV300
LV600-KLOCK	All LV600 and LV1200

Note:

(1) Kits replace free chain latch on LV models with a fixed member prohibiting disengagement and the ability to free chain.

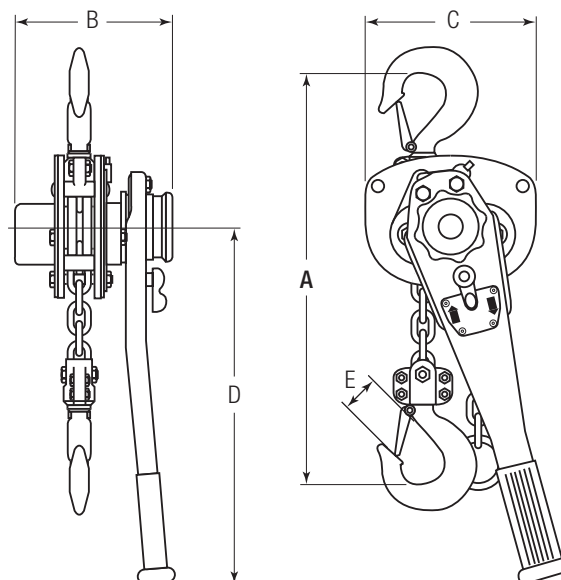

SL “Silver” Series Lever Chain Hoist

3/4 – 6 metric ton Line Pull Capacity



Features:

Our value priced lever hoist with industrial rated performance. One hand operation with the best free chaining available. If a load is applied in the free chain mode, the brake will automatically engage, minimizing operator setup error.

- 3/4 - 6 ton capacities.
- All steel construction.
- 360 degree handle rotation.
- Rubber handle grip in all sizes.
- Reliable disc brake.
- Premium grade 100 alloy load chain.
- Hardened swivel-latch hooks.
- Light weight.
- Low handle force.
- Short handle stroke.
- Standard lifts of 5, 10, 15, and 20 feet. Longer lifts available.

Options:

- Bullard bottom hooks for single fall models only.
- Non-standard lifts.

SL Series Specifications

Model no.	Capacity		Pull to lift rated load lbs	Net wt of chain per ft of lift lbs	No. of chain falls	Load chain size mm	Ship wt w/5 ft of lift lbs
	metric tons	lbs					
SL150	3/4	1650	68	0.53	1	6.0 x 18.0	15.5
SL200	1	2200	64	0.53	1	6.0 x 18.0	15.4
SL300	1-1/2	3300	73	11.73	1	7.1 x 21.2	24.3
SL600	3	6600	75	1.48	1	10.0 x 30.0	44.1
SL1200	6	13200	81	2.95	2	10.0 x 30.0	67.1

Note:

Standard lift 5, 10, 15, and 20 ft.

SL Series Dimensions (in.)

Model	A (Min)	B	C	D	E	F	G	H	J
SL150	12.6	5.5	0.95	1.10	0.86	3.5	10.6	6.3	0.62
SL200	13	4.3	1.05	1.20	1.04	3.7	11.2	6.3	0.63
SL300	14.8	7.1	1.20	1.30	1.10	4.2	15.4	7.7	0.80
SL600	18.7	8.7	1.55	1.70	1.50	5.5	15.4	8.7	1.10
SL1200	24.0	10.2	1.60	1.90	1.80	6.3	15.4	8.7	1.30

Note:

Dimensions are subject to change.

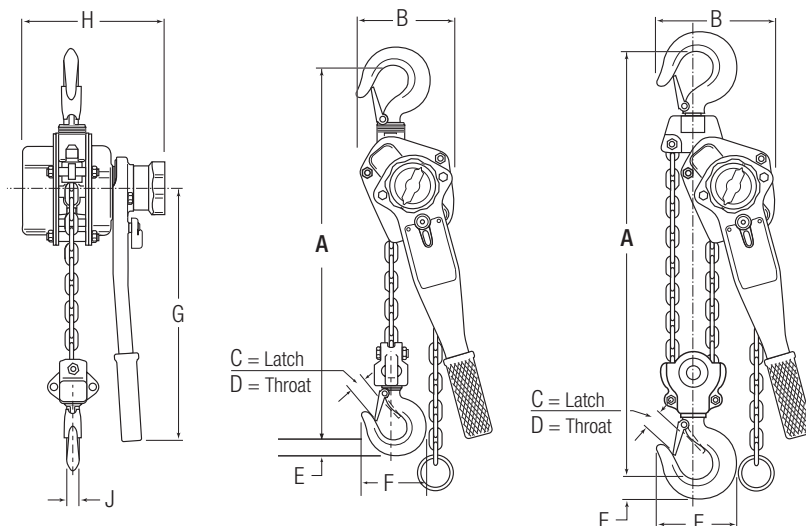

VL2 “Premium” Series Manual Chain Hoist



1/2 – 20 metric ton Lifting Capacity

Features:

Our top of the line manual chain hoist, the VL2 Series exclusive hand chain guide provides smooth, even operation and eliminates jamming when operated away from the load area. Perfect for construction, maintenance, rigging and shipbuilding.

- “Accu-Feed™” hand chain guide articulates for smooth operation and allows for operation from either side away from load being lifted.
- All steel construction for external impact resistance.
- Forged steel alloy load hooks with non-slip design have extra wide throat openings for easy rigging.
- Premium alloy steel grade 100 load chain.
- Thrust bearing bottom block on 3 ton and above helps prevent chain twisting or kinking.
- Chain anchor prevents jamming at the hook’s lowest position.
- Needle bearings reduce friction and provide low hand chain pull.
- **Overload Protection** to deter and reduce downtime and repair costs resulting from abuse.
- Available in standard lifts of 10, 15 and 20 feet. Hand chain is 2 feet less than lift.



Options:

- Spark and corrosion resistant models.
- Spark and corrosion resistant load and hand chain.
- Non standard lifts.
- Chain buckets.
- Protective coatings.
- Bullard bottom hooks for single fall models only.

Nylon bushed VL2 hoist hand chain guide. Zinc plated hand chain shown

VL2 Series Specifications

Model no.	Capacity		Pull to lift rated load lbs	Chain o’hauled to lift load 1 ft	Net wt of chain per ft of lift lbs	No. of chain falls	Load chain size mm	Ship wt w/10 ft of lift lbs
	metric tons	lbs						
VL2-005	1/2	1100	55	25	.356	1	5.0 x 15.0	20
VL2-010	1	2200	73	28	.569	1	6.3 x 19.2	26
VL2-015	1 1/2	3300	74	57	.744	1	7.1 x 21.2	45
VL2-020	2	4400	76	73	1.030	1	8.0 x 24.2	50
VL2-030	3	6600	76	112	1.488	2	7.1 x 21.2	52
VL2-050	5	11000	85	181	2.38	2	9.0 x 27.2	94
VL2-080	8	17600	90	272	3.57	3	9.0 x 27.2	150
VL2-100	10	22000	90	362	4.76	4	9.0 x 27.2	188
VL2-150	15	33000	2 x 90	2 x 272	7.14	6	9.0 x 27.2	395
VL2-200	20	44000	2 x 90	2 x 362	9.52	8	9.0 x 27.2	485

Note:
Standard lift 10, 15, and 20 ft.

VL2 Series Dimensions (in.)

Base model	A (min)	B	C	D
VL2-005	12	5 11/16	5	1 1/16
VL2-010	13 5/8	6 3/16	5 13/16	1 3/16
VL2-015	14 5/8	6 7/8	5 13/16	1 11/32
VL2-020	16 3/4	8	7 1/16	1 15/32
VL2-030	19 7/8	8 1/8	5 13/16	1 19/32
VL2-050	25	10 3/8	7 1/16	1 7/8
VL2-080	29 1/8	13 5/8	7 1/16	2 5/8
VL2-100	29 15/16	14 7/16	7 1/16	2 5/8
VL2-150	33 1/2	29 3/8	8 3/16	3 7/16
VL2-200	34 1/4	34 3/8	8 3/16	3 7/16

Note:
Dimensions are subject to change.

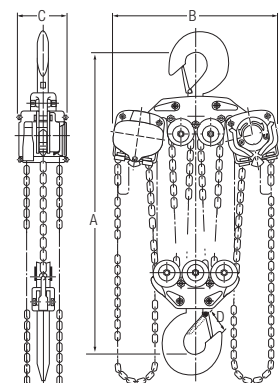
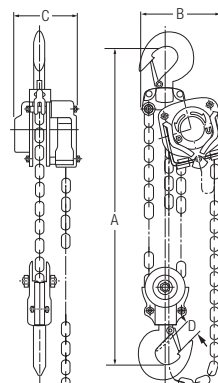
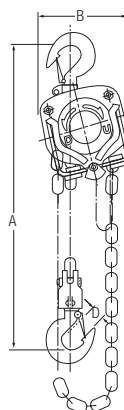
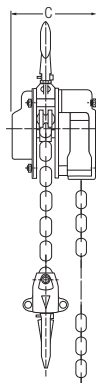

1/2 through 2 tons

3 through 10 tons

15 and 20 tons

MCH5 “Classic” Series Manual Chain Hoist



1/2 – 5 metric ton Lifting Capacity

Features:

Downscaled version of the VL2 for applications with lower duty cycles. Ideal for maintenance use application.

- Compact design for limited headroom applications.
- High strength steel frame and gear case built to be durable for the rugged needs of construction and maintenance rigging.
- Heat-treated spur gear is efficiently designed to provide smooth load handling and low hand chain pull.
- Open frame design for self-cleaning, quick load sheave inspection and easy hoist maintenance.
- Designed to international standards, non-slip load hooks and top hooks are fitted with hook latches.
- Premium alloy steel grade 100 load chain.
- Standard lifts 10, 15, and 20 feet available from stock.

Options:

- Spark and corrosion resistant load and hand chain.
- Overload protection.
- Chain buckets.
- Bullard bottom hooks for single fall models only.

MCH5 Series Specifications

Model no.	Capacity		Pull to lift rated load lbs	Chain o’hauled to lift load 1 ft	Net wt of chain per ft of lift lbs	No. of chain falls	Load chain size mm	Ship wt w/10 ft of lift lbs
	metric tons	lbs						
MCH5-005	1/2	1100	59	25	.356	1	5.0 x 15.0	20
MCH5-010	1	2200	76	39	.569	1	6.3 x 19.2	26
MCH5-015	1 1/2	3300	78	58	.744	1	7.1 x 21.2	45
MCH5-020	2	4400	80	75	1.03	1	8.0 x 24.2	50
MCH5-030	3	6600	81	116	1.488	2	7.1 x 21.2	52
MCH5-050	5	11000	89	187	2.38	2	9.0 x 27.2	94

Note:

Standard lift 10, 15, and 20 ft.

MCH5 Series Dimensions (in.)

Base model	A (min)	B	C	D
MCH5-005	12	5 ¹¹ / ₁₆	5	1 ¹ / ₁₆
MCH5-010	13 ⁵ / ₈	6 ³ / ₁₆	5 ³ / ₄	1 ³ / ₁₆
MCH5-015	14 ⁵ / ₈	6 ⁷ / ₈	5 ³ / ₄	1 ³ / ₈
MCH5-020	16 ³ / ₄	8	7	1 ⁷ / ₁₆
MCH5-030	19 ⁷ / ₈	8 ¹ / ₈	5 ³ / ₄	1 ¹¹ / ₁₆
MCH5-050	25	10 ³ / ₈	7	1 ⁷ / ₈

Note:

Dimensions are subject to change.

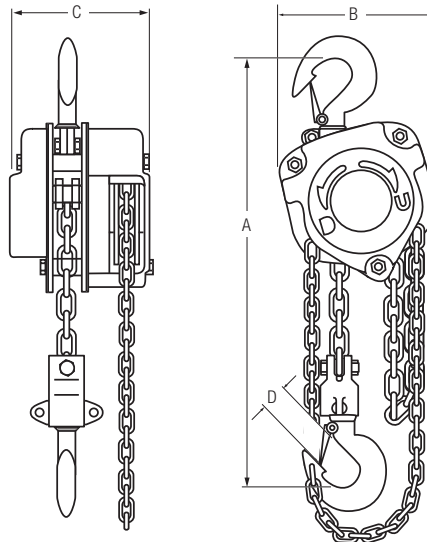

SMA "Silver" Series Manual Chain Hoist



1/2 – 5 metric ton Lifting Capacity

Features:

A NEW design for the year 2000 workplace with safety and performance in mind. Meets or exceeds world specifications including ASME B30.16. A value line product with premium features at a Great Price.

- Overload Protection to deter and reduce downtime and repair costs resulting from abuse.
- All steel, low headroom, light weight construction.
- Self-adjusting disc type double pawl mechanical load brake.
- Hardened roller bearings for maximum efficiency and durability.
- Improved 4 layer finish of nickel, copper, nickel, and chrome complementing our Silver Series lever hoist companion product.
- Ideally suited for the Rental and Construction markets.
- Standard lift (L) is 10 feet, Hand chain drop (D) is 2 feet less than lift (unless specified).

Options:

- Bullard bottom hooks for single fall models only.



SMA Series Specifications

Model no.	Capacity		Pull to lift rated load lbs	Chain o'hailed to lift load 1 ft	Net wt of chain per ft of lift lbs	No. of chain falls	Load chain size mm	Ship wt w/10 ft of lift lbs
	metric tons	lbs						
SMA005	1/2	1100	48	25	.55	1	6.3 x 18	18
SMA010	1	2200	75	39	.55	1	6.3 x 18	26
SMA015	1 1/2	3300	84	58	.80	1	8.0 x 24	39
SMA020	2	4400	81	75	1.10	2	6.3 x 19	35
SMA030	3	6600	90	116	1.60	2	8.0 x 24	55
SMA050	5	11000	97	187	1.40	2	10.0 x 30	86

Note:
Standard lift 10

SMA Series dimensions (in.)

Model	A (min)	B	C	D	E	F	G	J
SMA005	11.6	5.3	.82	.85	.60	2.8	4.2	.59
SMA010	13.0	5.7	1.0	1.1	.78	3.6	5.1	.75
SMA015	16.1	7.6	1.1	1.2	.97	4.1	5.8	.87
SMA020	17.7	5.7	1.2	1.3	1.1	4.5	5.1	.98
SMA030	20.7	7.6	1.4	1.5	1.4	5.1	5.8	1.1
SMA050	24.0	8.3	1.5	1.7	1.7	5.9	6.6	1.3

Note:
Dimensions are subject to change.

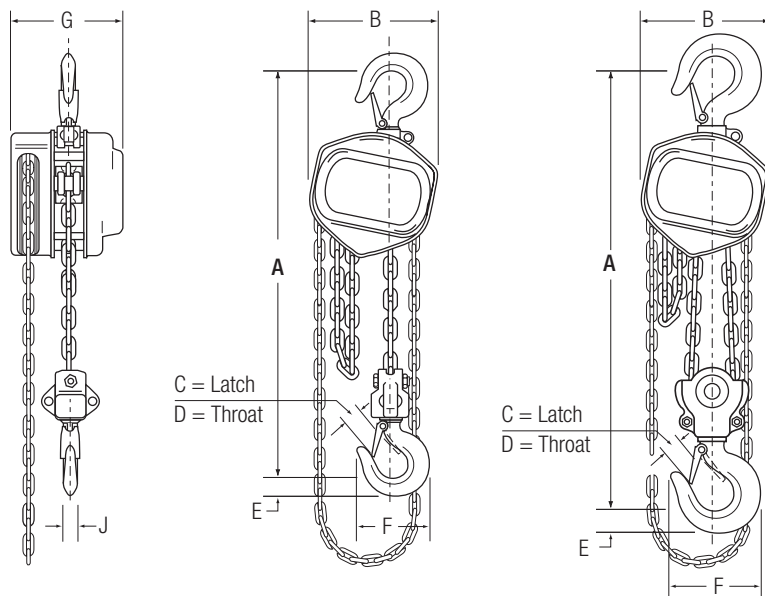

OVERLOAD PROTECTION
For Your Safety

THV “Lo-Pro” Series Manual Chain Hoist

1/2 – 10 metric ton Lifting Capacity



Features:

Low headroom “Army Style” type trolley hoist

- Utilizes our premium VL2 hoist with a “low profile” trolley.
- All steel construction for external impact resistance.
- Forged steel alloy load hooks with non-slip design have extra wide throat openings for easy rigging.
- Premium grade 100 alloy steel load chain.
- Contour trolley wheel design provides maximum beam contact on flat or tapered beams.
- Thrust bearing bottom block helps prevent chain twisting or kinking.
- Overload Protection to deter and reduce downtime and repair costs resulting from abuse.
- Needle bearings reduce friction and provide low hand chain pull.
- Overload clutch.

Options:

- Spark and corrosion resistant models available.
- Trolley shaft extensions for wider flanges.
- Trolley lugs and rubber bumpers.
- Chain containers.
- Choice of plain or geared trolleys.
- Variable lengths of lift for special requirements.
- Special inquiries invited.
- Bullard bottom hooks for single fall models only.



THV Series Specifications

Model no.	Capacity		Pull to lift rated load lbs	Chain o’hailed to lift load 1 ft	Net wt of chain per ft of lift lbs	No. of chain falls	Load chain size mm	Ship wt w/10 ft of lift lbs in.	Std flange adjustment in.	Shipping wt trolley type	
	metric tons	lbs								Plain	Geared
THV005	1/2	1100	55	25	.95	1	5.0 x 15.0	15	2.5 – 5	35	38
THV010	1	2200	73	39	1.16	1	6.3 x 19.2	29	2.5 – 5	50	54
THV020	2	4400	76	75	1.51	1	8.0 x 24.2	37	3 – 5	90	96
THV030	3	6600	76	116	2.08	2	7.1 x 21.2	44	3 – 5	120	128
THV050	5	11000	85	187	3.00	2	9.0 x 27.2	55	3 – 5	205	255
THV080	8	18000	90	281	4.21	3	9.0 x 27.2	60	4 – 6	385	420
THV100	10	22000	90	375	5.42	4	9.0 x 27.2	60	4 – 6	455	480

Note:

Standard lift 10

Standard hand chain length for hoist and trolley is 2 feet less than lift.

THV Series Dimensions (in.)

Base model	A (min)	C	D	E	F	G	H	I
THV005	10 ⁵ / ₈	10	4 ¹ / ₂	5 ¹ / ₂	3 ³ / ₄	1 ¹ / ₁₆	1 ¹ / ₂	4 ¹ / ₄
THV010	12 ¹¹ / ₁₆	10	4 ¹ / ₂	5 ¹ / ₂	7 ⁷ / ₈	1 ¹ / ₈	1 ¹ / ₂	4 ¹ / ₄
THV020	15 ³ / ₁₆	12 ⁵ / ₈	5 ³ / ₈	7 ¹ / ₈	1 ³ / ₈	1 ¹ / ₂	1 ¹ / ₈	5
THV030	17 ³ / ₈	14	6 ¹ / ₄	7 ⁷ / ₈	1 ¹ / ₂	1 ⁵ / ₈	1 ¹ / ₂	5 ³ / ₄
THV050	21 ¹ / ₂	17 ¹ / ₂	7	10 ¹ / ₂	1 ⁷ / ₈	1 ³ / ₄	1 ⁷ / ₁₆	6 ⁵ / ₈
THV080	26 ³ / ₄	20 ¹ / ₂	7 ³ / ₄	9 ⁷ / ₈	2 ⁷ / ₈	2 ¹ / ₂	1 ³ / ₁₆	7 ³ / ₈
THV100	27 ⁵ / ₈	20 ¹ / ₂	7 ³ / ₄	9 ⁷ / ₈	2 ⁷ / ₈	2 ¹ / ₂	1 ³ / ₁₆	7 ³ / ₈

THV Series Dimensions (in.) continued

Base model	J	K	L	N	P	Q	R	T ¹
THV005	2 ³ / ₄	b + 1 ⁷ / ₈	1 ³ / ₈	b - 1 ⁷ / ₈	2 ³ / ₄	6 ¹ / ₄	1 ¹ / ₂	11 ⁵ / ₈
THV010	2 ³ / ₄	b + 1 ⁷ / ₈	1 ³ / ₈	b - 1 ⁷ / ₈	2 ³ / ₄	6 ³ / ₈	5 ⁵ / ₈	11 ⁵ / ₈
THV020	3 ³ / ₈	b + 2	1 ¹ / ₂	b - 2 ¹ / ₈	3 ¹ / ₂	7 ¹ / ₄	7 ⁷ / ₈	11 ⁵ / ₈
THV030	4	b + 2 ¹ / ₈	1 ⁵ / ₈	b - 2 ³ / ₈	3 ¹ / ₈	6 ³ / ₄	1 ¹ / ₈	12
THV050	4 ³ / ₄	b + 2 ³ / ₄	2 ¹ / ₈	b - 2 ⁷ / ₈	3 ¹ / ₂	7 ¹ / ₂	1 ³ / ₈	14 ¹ / ₂
THV080	6 ¹ / ₈	b + 3 ¹ / ₄	2 ³ / ₈	b - 3 ¹ / ₂	4	8 ¹ / ₄	2 ¹ / ₈	18 ³ / ₄
THV100	6 ¹ / ₈	b + 3 ¹ / ₄	2 ³ / ₈	b - 3 ¹ / ₂	4	8 ¹ / ₄	2 ¹ / ₈	18 ³ / ₄

Note:

(1) Applicable for geared trolleys only.

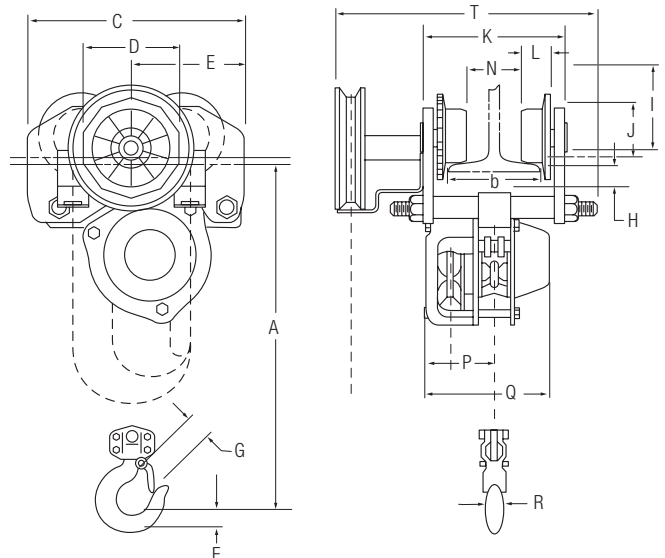

ULM2/S “Ultra-Lo” Series Manual Chain Hoist



1/4 – 25 US Ton Lifting Capacity

Features:

Ingersoll-Rand's ULM2 and ULM2S have been designed to offer our lowest headroom possible, maximizing lifting capacities for areas with height restrictions.

- All steel construction for external impact resistance.
- Forged steel load hooks.
- Chill-hardened, machine tread trolley wheels with 2 precision bearings per wheel.
- Swivel trolleys available to travel extremely tight radius, (as tight as 21 feet) for track without sacrificing headroom for capacities up to 6 ton.
- Custom built for easy installation.
- Low headroom capacities available from 1/4 through 25 ton.
- 2 roller thrust bearings used in trolley capacities 3 tons and larger for longer life and reliability.
- Corrosion resistant zinc plated hand chain.
- Designed and built to ANSI B30.16.

Options:

- Stainless steel and bronze parts available for spark resistant features.
- Corrosion resistant finish.
- Overload clutch for all capacities.
- Chain container for all capacities and all lifts up to 50 feet.
- Track clamps.
- Hand wheel extensions.
- Zinc plated load chain.



ULM2 and ULM2S Series Specifications

Model no.	Capacity		Pull to lift rated load lbs	Chain o'hauled to lift load 1 ft	No. of chain falls per side	Load chain size mm	Straight track flange adj in.	Min curve radius in.	Max width for min curve radius in.	Ship wt trolley type	
	US tons	lbs								Plain	Geared lbs
ULM2 Series											
ULM2-015	1½	3000	41	87	1 x 1	7.14	3.33-8.00	78	—	207	230
ULM2-020	2	4000	54	87	1 x 1	7.14	3.33-8.00	78	—	210	233
ULM2-030	3	6000	42	176	2 x 2	7.14	4.00-8.00	78	—	305	355
ULM2-040	4	8000	56	176	2 x 2	7.14	4.00-8.00	90	—	308	340
ULM2-050	5	10000	79	165	1 x 1	13.49	4.63-8.00	102	—	574	633
ULM2-060	6	12000	94	165	1 x 1	13.49	4.63-8.00	102	—	574	633
ULM2-080	8	16000	64	355	2 x 2	9.53	4.63-8.00	114	—	650	773
ULM2-100	10	20000	87	330	2 x 2	13.49	5.00-8.00	—	—	1022	1105
ULM2-120	12	24000	104	330	2 x 2	13.49	5.00-8.00	—	—	1022	1105
ULM2-160	16	22000	68	710	4 x 2	9.53	5.00-8.00	—	—	1600	1681
ULM2-200	20	40000	87	732	4 x 2	13.49	6.00-8.00	—	—	1950	2110
ULM2-240	24	48000	104	732	4 x 2	13.49	6.00-8.00	—	—	1950	2110
ULM2-250	25	50000	104	732	4 x 2	13.49	6.00-8.00	—	—	1950	2110
ULM2S Series											
ULM2S003	¼	500	17	33	1 x 1	7.14	3.00-5.38	21	3.38	110	127
ULM2S005	½	1000	35	33	1 x 1	7.14	3.00-5.38	21	3.38	127	144
ULM2S010	1	2000	70	33	1 x 1	7.14	3.00-5.38	21	3.38	127	144
ULM2S015	1½	3000	57	66	2 x 2	7.14	3.31-6.00	30	4.00	245	267
ULM2S020	2	4000	76	66	2 x 2	7.14	3.31-6.00	30	4.00	251	270
ULM2S030	3	6000	42	170	2 x 2	7.14	4.00-6.00	42	5.88	345	375
ULM2S040	4	8000	58	170	2 x 2	7.14	4.00-6.00	48	5.88	350	380
ULM2S050	5	10000	73	170	2 x 2	7.14	4.63-8.00	48	7.88	466	496
ULM2S060	6	12000	90	170	2 x 2	7.14	4.63-8.00	48	7.88	466	496

Note:

Standard lift is 8 ft.

Maximum flange thickness for ULM2S003–030 is 1/2 in., ULM2S040–060 is 5/8 in.

ULM2/S "Ultra-Lo" Series Manual Chain Hoist

1/4 – 25 US Ton Lifting Capacity



ULM2 and ULM2S Beam Flange Chart (in.)

Plain and geared trolleys for straight and curved track

	Capacity US Tons	Fits flange width for straight track	Max flange width for min curve radius	flange thickness for radius min	max
ULM2 Series					
ULM2-015, ULM2-020	1 1/2, 2	3 3/8 – 8	–	–	–
ULM2-030, ULM2-040	3, 4	4 – 8	–	–	–
ULM2-050, ULM2-060, ULM2-080	5, 6, 8	4 5/8 – 8	–	–	–
ULM2-100, ULM2-120	10, 12	5 – 8	–	–	–
ULM2-160, ULM2-200	16, 20	5 1/2 – 8	–	–	–
ULM2-240, ULM2-250	24, 25	6 – 8	–	–	–
ULM2S Series					
ULM2S003, ULM2S005, ULM2S010	1/4, 1/2, 1	3 – 5 3/8	3 3/8	21	1/2
ULM2S015, ULM2S020	1 1/2, 2	3 3/8 – 6	4	30	1/2
ULM2S030, ULM2S040	3, 4	4 – 6	5 7/8	42	5/8
ULM2S050, ULM2S060	5, 6	4 5/8 – 8	7 7/8	48	7/8

Note:

Contact Technical Sales for wider beam flange applications.

ULM2 Series Dimensions (in.)

Capacity U.S. Tons	A (min)	B	C	D	E	E1	F	G	H	J	L	M	N ¹	P ²	R	S
1 1/2 & 2	6 1/4	20 3/8	10 3/16	10 3/16	5 1/8	5 1/8	8 3/4	8 1/4	5/8	1 1/8	1 1/8	4 1/2	1/2	6" I@ 12.5#	13 1/16	6
3	7 3/8	20 3/8	10 3/16	10 3/16	6 1/2	6 5/8	10 5/8	10 5/8	9/16	1 11/32	1 11/32	6 3/8	1/2	8" I@ 18.4#	13 1/16	8
4	8	20 3/8	10 3/16	10 3/16	6 1/2	6 5/8	10 5/8	10 5/8	9/16	1 11/16	1 11/32	6 3/8	1/2	8" I@ 18.4#	13 1/16	8
5 & 6	8 3/4	26 1/4	13 1/8	13 1/8	7 3/8	7 3/8	12	12	29/32	1 11/16	1 11/32	7 3/16	9/16	10" I@ 25.4#	16 1/2	9
8	11	26 1/4	13 1/8	13 1/8	8 3/8	8 3/8	14	13 1/2	9/16	2 1/16	1 11/16	8 1/4	9/16	10" I@ 25.4#	16 1/2	10
10 & 12	11 1/2	26 1/4	13 1/8	13 1/8	8 1/2	9 3/4	15 5/8	14 3/8	9/16	2 1/4	1 3/4	9 3/4	5/8	12" I@ 31.8#	16 1/2	11 11/16
16	13 5/8	30 3/8	15 3/16	15 3/16	11 7/8	11 7/8	18 5/8	18 5/8	9/16	3	2	11 3/4	3/4	15" I@ 42.9#	18 7/8	13 1/2
20, 24 & 25	17 1/4	30 3/8	15 3/16	15 3/16	12 1/8	12 3/8	19 1/4	19	3/4	3 5/8	2	11 3/4	5/8	18" I@ 54.7#	18 7/16	13 1/2

Note:

(1) At under beam roller

(2) Minimum standard I-Beam for proper wheel running clearance. Contact factory for smaller beams. Customer must verify their beam is adequate for applied loads.

ULM2S series dimensions (in.)

Capacity U.S. Tons	A (min)	B	C	D	E	F	G ¹	G ²	H	I	J	K ²	L ²	M	N	O
1/4 thru 1	6 1/4	2	6 9/16	6 9/16	3 3/4	5	2 3/16	1 1/8	3 1/32	4 11/16	3 3/4	7 1/4	6 1/2	2 1/2	1 3/8	2 15/16
1 1/2 & 2	6 3/4	2 3/16	9 1/8	9 1/8	4 1/2	6	5/8	5/8	1 1/8	7 3/16	6 1/4	11 3/8	7 5/8	3	3	1 7/8
3	8 3/4	2 9/16	9 7/8	9 7/8	6 3/8	8	15/16	15/16	1 11/32	8 1/8	6 1/8	11 9/16	7 11/16	4	3	1 7/8
4	9 1/4	2 9/16	9 7/8	9 7/8	6 3/8	8	15/16	15/16	1 11/16	8 1/8	6 1/8	11 9/16	7 11/16	4	3	3 7/16
5 & 6	9 15/16	2 13/16	10 1/8	10 1/8	7 3/16	9	7/8	7/8	1 11/16	8 1/2	6 15/16	11 9/16	8 13/16	4 1/2	3	3 7/8

Note:

(1) Plain

(2) Geared

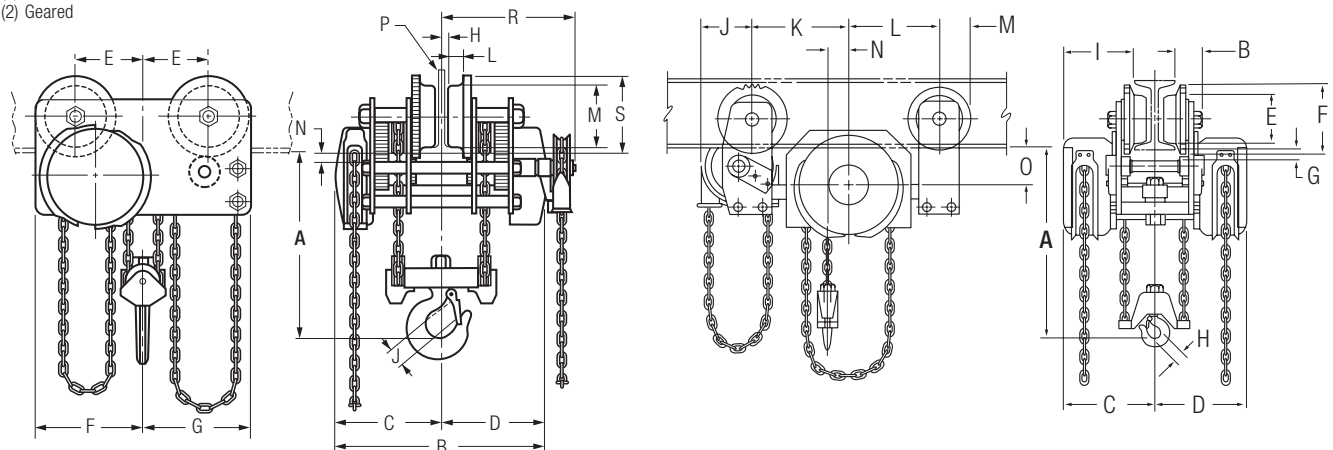

ULM2

ULM2S